

SCHEDULE 1 - List of parcels within Agreement Area

Acraman Creek Conservation Park

Parcel Identifier	Hundred	Title Reference	Proclamation Date
D30252A10	Wallanippie	CR 5772/925	12 September 1991
D30252A11 (portion covered by the Determination)	Wallanippie	CR 5772/925	12 September 1991
D36577A103	Wallanippie	CR 5772/925	4 November 1993
D37675A109	Wallanippie	CR 5772/925	4 November 1993

Boondina Conservation Park

Parcel Identifier	Hundred	Title Reference	Proclamation Date
H834300S79	OH (Fowler)	CR 5977/154	29 June 2006

Chadinga Conservation Park

Parcel Identifier	Hundred	Title Reference	Proclamation Date
H630400S18	Giles	CR 5772/456	27 May 2010
H630400S19	Giles	CR 5772/456	27 May 2010
H630400S20	Giles	CR 5772/456	27 May 2010
H630400S25	Giles	CR 5772/456	27 May 2010
D34576A2	Giles	CR 5772/456	27 May 2010
H630300S31	Cohen	CR 5772/456	27 May 2010
H630600S6	Kevin	CR 6011/373	27 May 2010
H630600S10	Kevin	CR 5767/638	27 May 2010
H630600S11	Kevin	CR 6011/373	27 May 2010
H630600S20	Kevin	CR 5945/69	27 May 2010
H630600S44	Kevin	CR 6011/373	27 May 2010
H630600S45	Kevin	CR 5945/69	27 May 2010
D34575A10	Kevin	CR 5772/456	27 May 2010

Fowlers Bay Conservation Park

Parcel Identifier	Hundred	Title Reference	Proclamation Date
D35535A100	Caldwell	CR 5772/806	30 November 2006
D35535A101	Caldwell and Sturdee	CR 5772/806	30 November 2006
D35363A62	Caldwell	CR 5772/806	30 November 2006
D35363A64	Caldwell	CR 5772/949	30 November 2006
H620200S40	Caldwell	CR 5403/209	To be added

Great Australian Bight Marine National Park

Parcel Identifier	Hundred	Title Reference	Proclamation Date
D57297A11	Russell	CR 5963/416	26 September 1996
D57675A21 (portion covered by the Determination)	OH (Nullarbor)	CR 5930/497	26 September 1996

Laura Bay Conservation Park

Parcel Identifier	Hundred	Title Reference	Proclamation Date
H660200S41	Blacker	CR 5772/898	15 February 1973
H660200S42	Blacker	CR 5772/898	15 February 1973
H660200S46	Blacker	CR 5772/898	29 May 1986
H660200S47	Blacker	CR 5772/898	2 August 1984
H660200S50	Blacker	CR 5772/898	11 October 1973
H660200S55	Blacker	CR 5772/898	15 February 1973
H660200s38	Blacker	CR 5772/461	To be added
H660200S48	Blacker	CR 5772/461	To be added
H660200S49	Blacker	CR 5772/461	To be added

Nullarbor National Park*

Parcel Identifier	Hundred	Title Reference	Proclamation Date
D89720A23*	OH(COOMPANA)	CR 6098/968	31 August 1989
D31597A10*	OH(NULLARBOR)	CR 6090/50	19 December 1991

*It is intended that D31597A10 be added to the Nullarbor Wilderness Protection Area and, subject to Parliamentary processes, that D89720A23 be added to the Nullarbor Regional Reserve at which time the Nullarbor National Park will be abolished.

Nullarbor Regional Reserve*

Parcel Identifier	Hundred	Title Reference	Proclamation Date
D89720A20	OH(COOK)	CR 6098/965	31 August 1989

*See note above re Nullarbor National Park

Nullarbor Wilderness Protection Area

Parcel Identifier	Hundred	Title Reference	Proclamation Date
D89720A21	OH(COOMPANA)	CR 6098/966	6 June 2013
D89720A22	OH(COOMPANA)	CR 6098/967	6 June 2013

*See note above re Nullarbor National Park

Point Bell Conservation Park

Parcel Identifier	Hundred	Title Reference	Proclamation Date
D38294A100	Keith	CR 5772/810	29 June 2006

Pureba Conservation Park*

Parcel Identifier	Hundred	Title Reference	Proclamation Date
D24908A100	Pethick	CR 5772/921	8 February 1990
D24907A300	Pureba	CR 5772/921	8 February 1990
D25122A400	OH (Streaky Bay)	CR 5772/921	25 January 1990
H610800S6	Pureba	CR 5772/921	10 October 1991
H610800S7	Pureba	CR 5772/921	10 October 1991
D34142A5	Pureba	CR 5778/24	29 June 2006
D34566A1	Pethick	CR 5778/24	29 June 2006
D34367A100	Nunnyah	CR 5772/476	29 June 2006

*Note - parcels outside the area of the Determination do not form part of the Agreement Area and are not listed above.

Wahgunyah Conservation Park

Parcel Identifier	Hundred	Title Reference	Proclamation Date
H620900S35	Wookata	CR 5963/417	23 August 2001
H620900S36	Wookata	CR 5963/417	23 August 2001
H620900S37	Wookata	CR 5963/417	23 August 2001
H620900S38	Wookata	CR 5963/417	23 August 2001
H620900S40	Wookata	CR 5963/417	23 August 2001
H620900S50	Wookata	CR 5963/417	23 August 2001
H620900S51	Wookata	CR 5963/417	23 August 2001
D57297A10	OH (Nullarbor)	CR 5963/415	23 August 2001
D38861A5	Wookata	CR 5963/417	23 August 2001
D53763A200	Wookata	CR 5866/882	21 April 2011
D53763A201	Wookata	CR 5866/882	21 April 2011
D67102A101	Wookata	CR 6070/571	21 April 2011
D85732A102	Wookata	CR 6070/569	21 April 2011
D85732A103	Wookata	CR 6070/570	21 April 2011
F53901A100	Wookata	CR 6070/329	21 April 2011
F53901A101	Wookata	CR 6070/329	21 April 2011
H620900S4	Wookata	CR 5749/652	21 April 2011
H620900S45	Wookata	CR 5866/882	21 April 2011
H620900S46	Wookata	CR 5866/882	21 April 2011
H620900S47	Wookata	CR 5749/652	21 April 2011
H620900S48	Wookata	CR 5866/882	21 April 2011
H620900S49	Wookata	CR 5749/652	21 April 2011
H620900S52	Wookata	CR 5749/652	21 April 2011
H620900S53	Wookata	CR 5749/652	21 April 2011
H620900S69	Wookata	CR 5767/622	21 April 2011
H620900S70	Wookata	CR 5916/576	21 April 2011
H620900S71	Wookata	CR 5916/576	21 April 2011
H620900S74	Wookata	CR 5749/652	21 April 2011

Far West Coast Parks - ILUA

H620900S77	Wookata	CR 5866/882	21 April 2011
H620900S86	Wookata	CR 5767/624	21 April 2011
H620900S87	Wookata	CR 5767/625	21 April 2011
H620900S88	Wookata	CR 5767/626	21 April 2011
H620900S89	Wookata	CR 5767/627	21 April 2011
H620900S94	Wookata	CR 5767/628	21 April 2011
D67302A57	Wookata	CR 5974/295	To be added

Wittelbee Conservation Park

Parcel Identifier	Hundred	Title Reference	Proclamation Date
H660300S101	Bonython	CR 5772/899	16 January 1969
H660300S175	Bonython	CR 5772/899	9 September 1976
D31612A1	Bonython	CR 5772/899	19 December 1991

Yellabinna Regional Reserve

Parcel Identifier	Hundred	Title Reference	Proclamation Date
D67929A100	OH (Barton)	CR 5957/384	25 January 1990

Yellabinna Wilderness Protection Area

Parcel Identifier	Hundred	Title Reference	Proclamation Date
D67929A101	OH (Barton)	CR 5952/891	11 August 2005

Yumbarra Conservation Park

Parcel Identifier	Hundred	Title Reference	Proclamation Date
H834300S457	OH (Fowler)	CR 5361/437	30 May 1968
H834300S1559	OH (Fowler)	CR 5361/437	25 January 1990
H661000S49	O'Loughlin	CR 5361/437	25 January 1990
D34677A100	O'Loughlin	CR 5977/155	29 June 2006
D24908A200	OH (Childara)	CR 5361/437	25 January 1990
D28783A2	OH (Fowler)	CR 5977/155	29 June 2006

SCHEDULE 2 - Maps of the Agreement Area



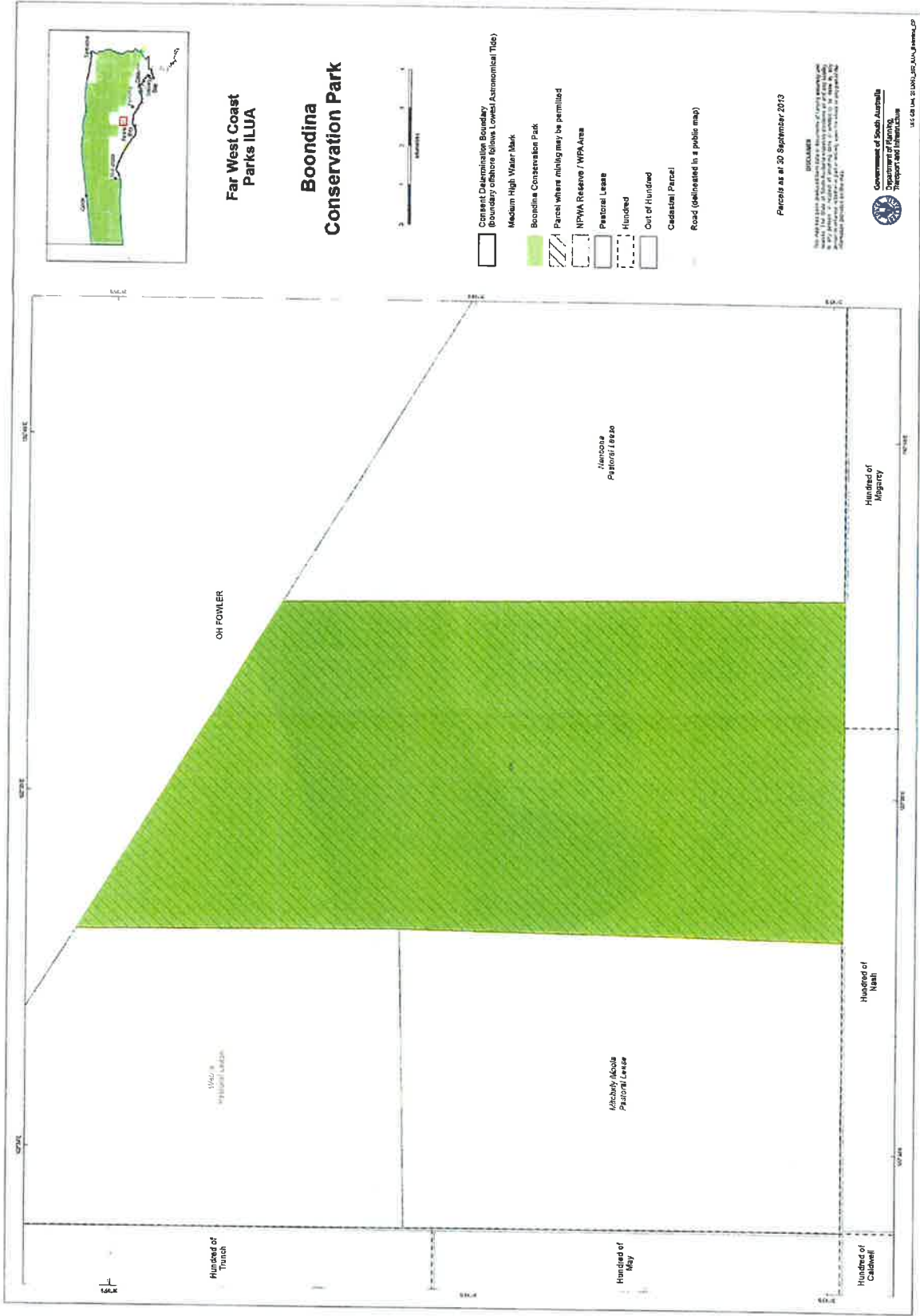

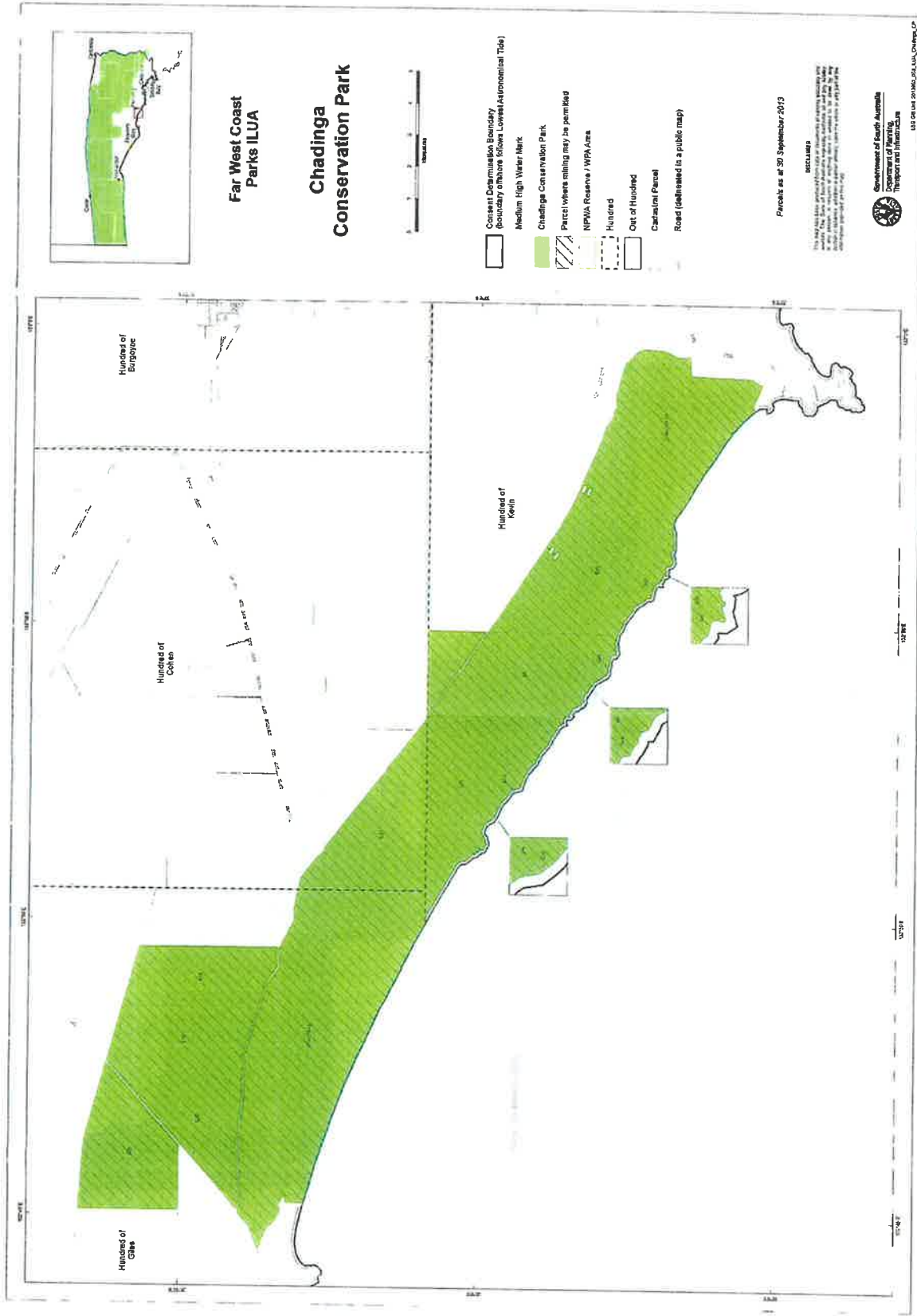

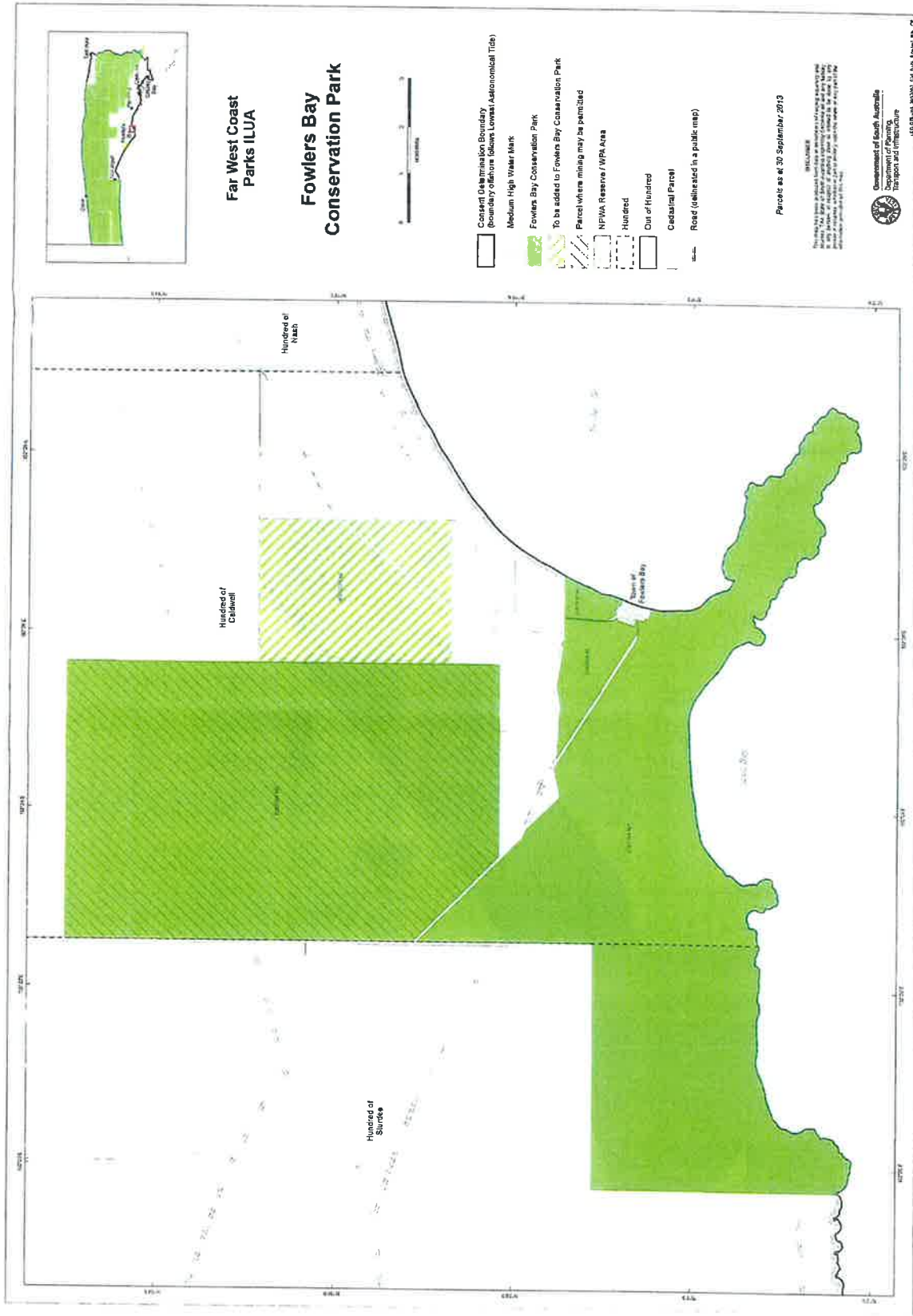

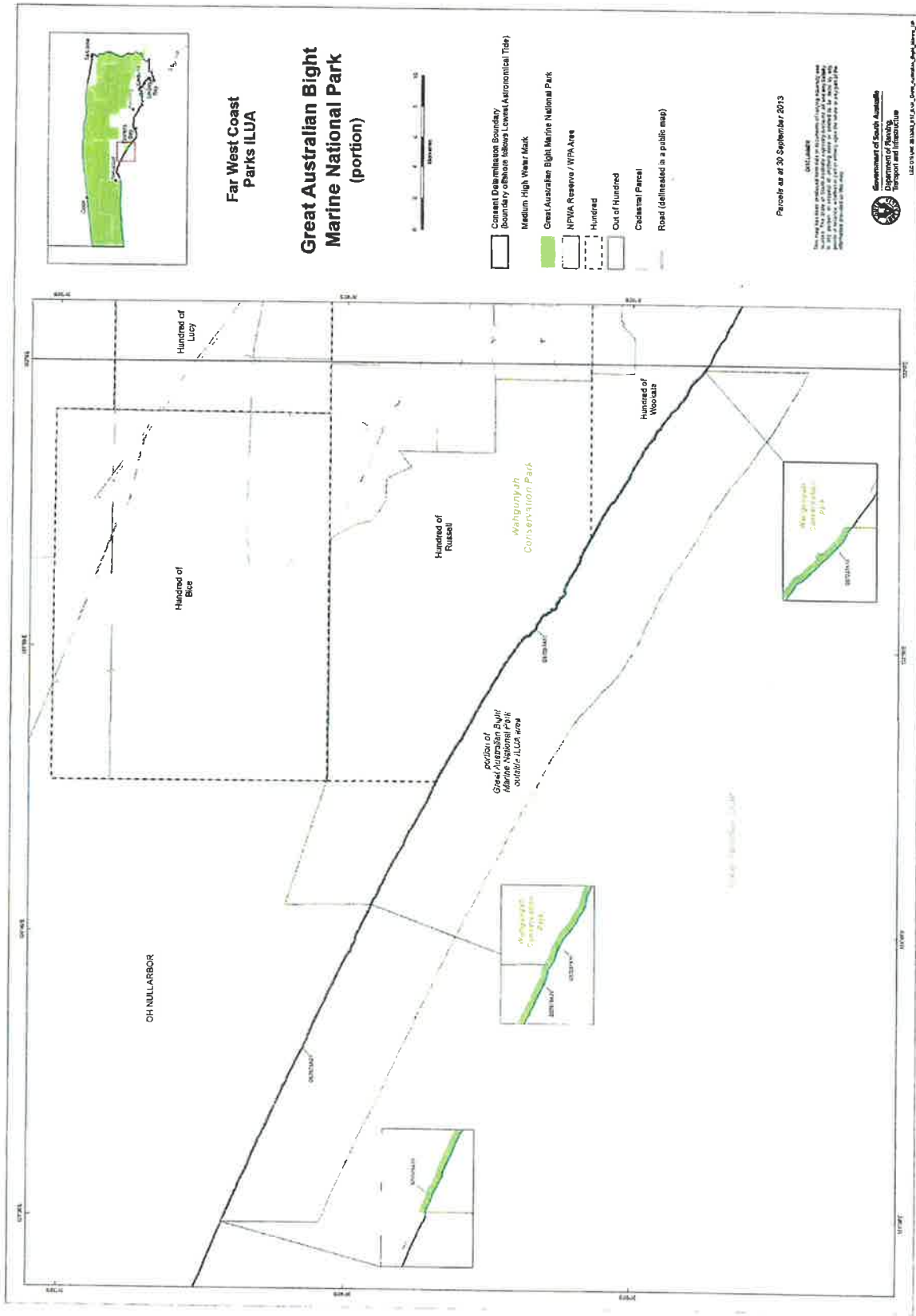

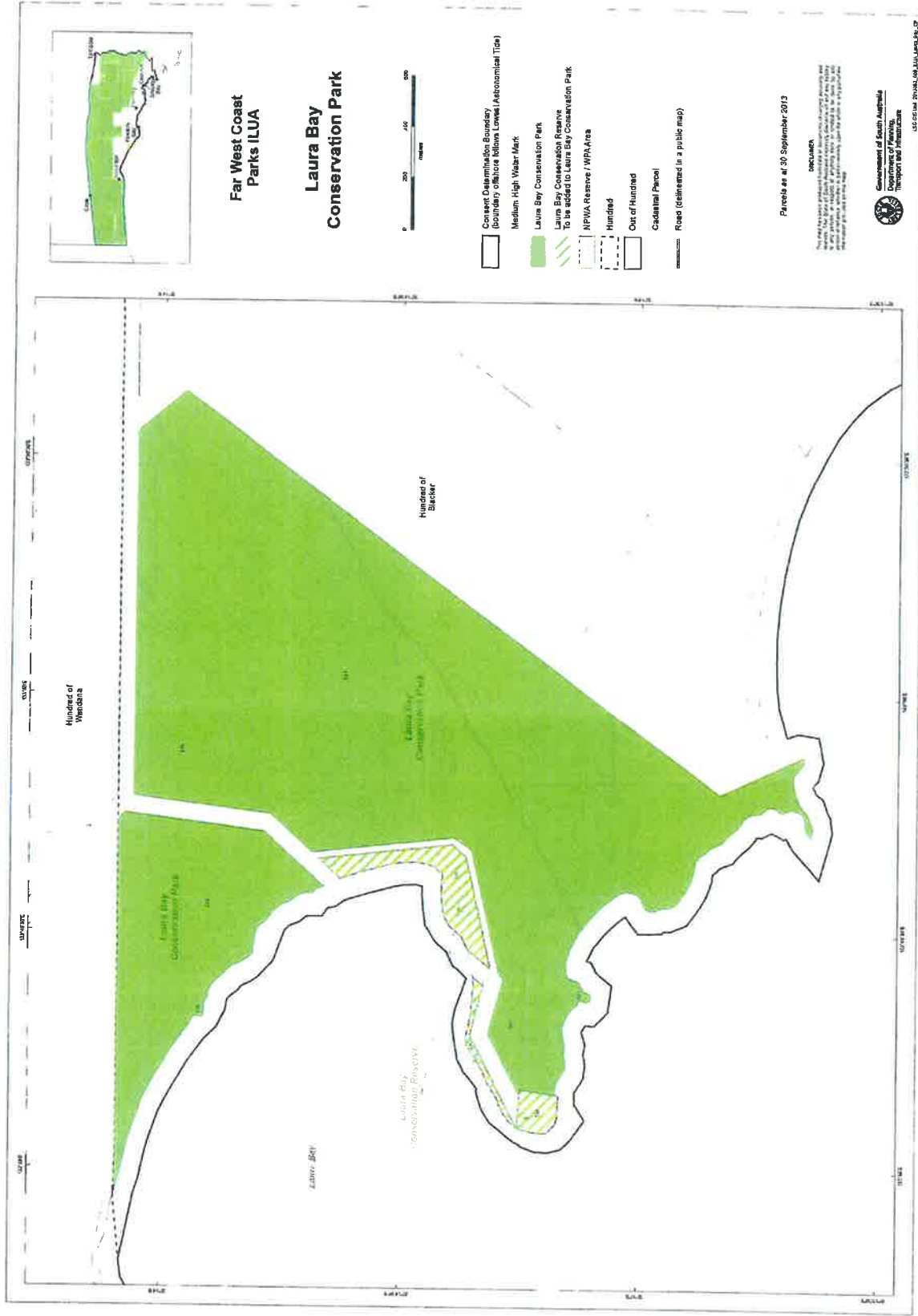

Far West Coast Parks - ILUA

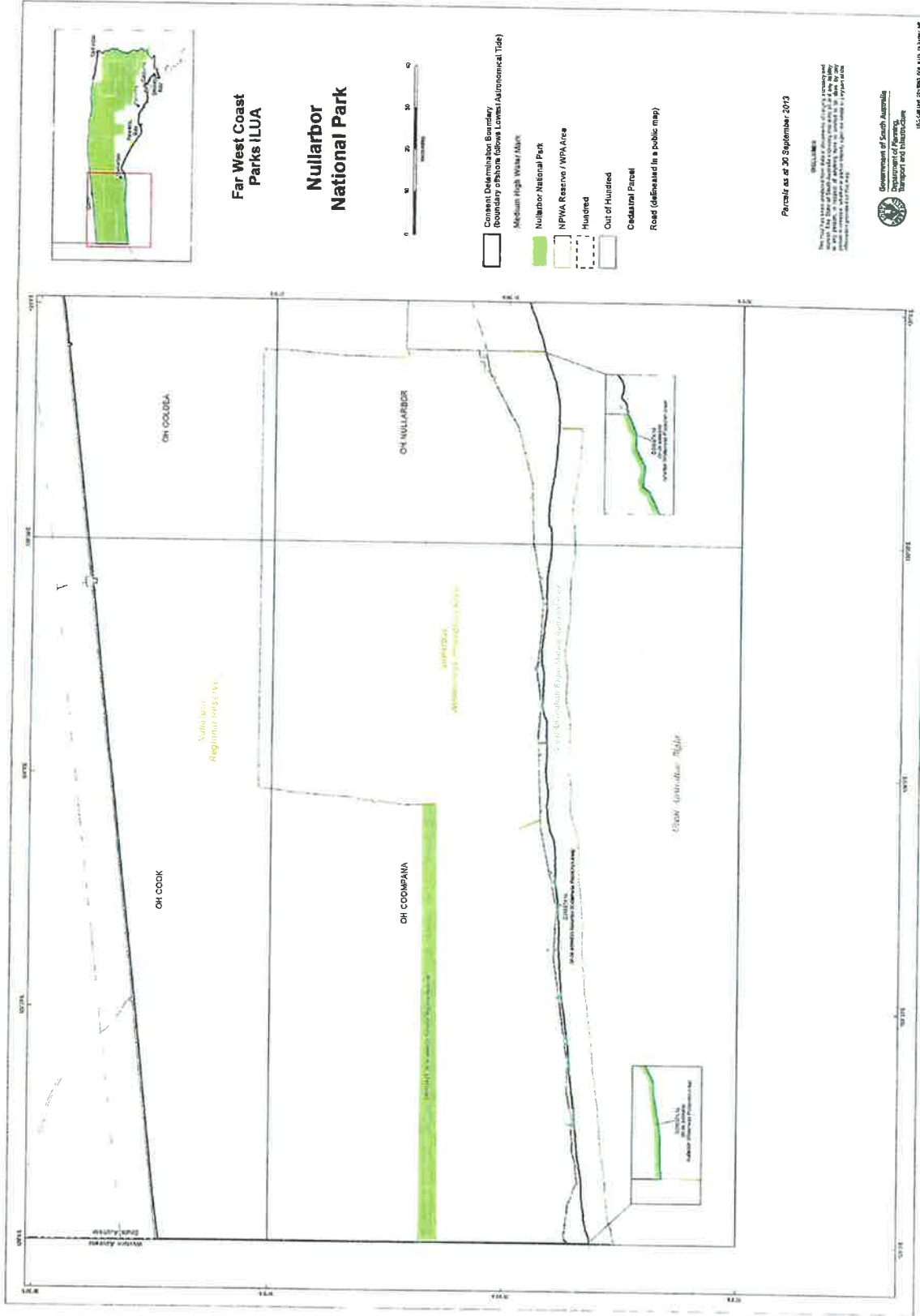

Far West Coast Parks - ILUA



Far West Coast Parks - ILUA



Far West Coast Parks - ILUA

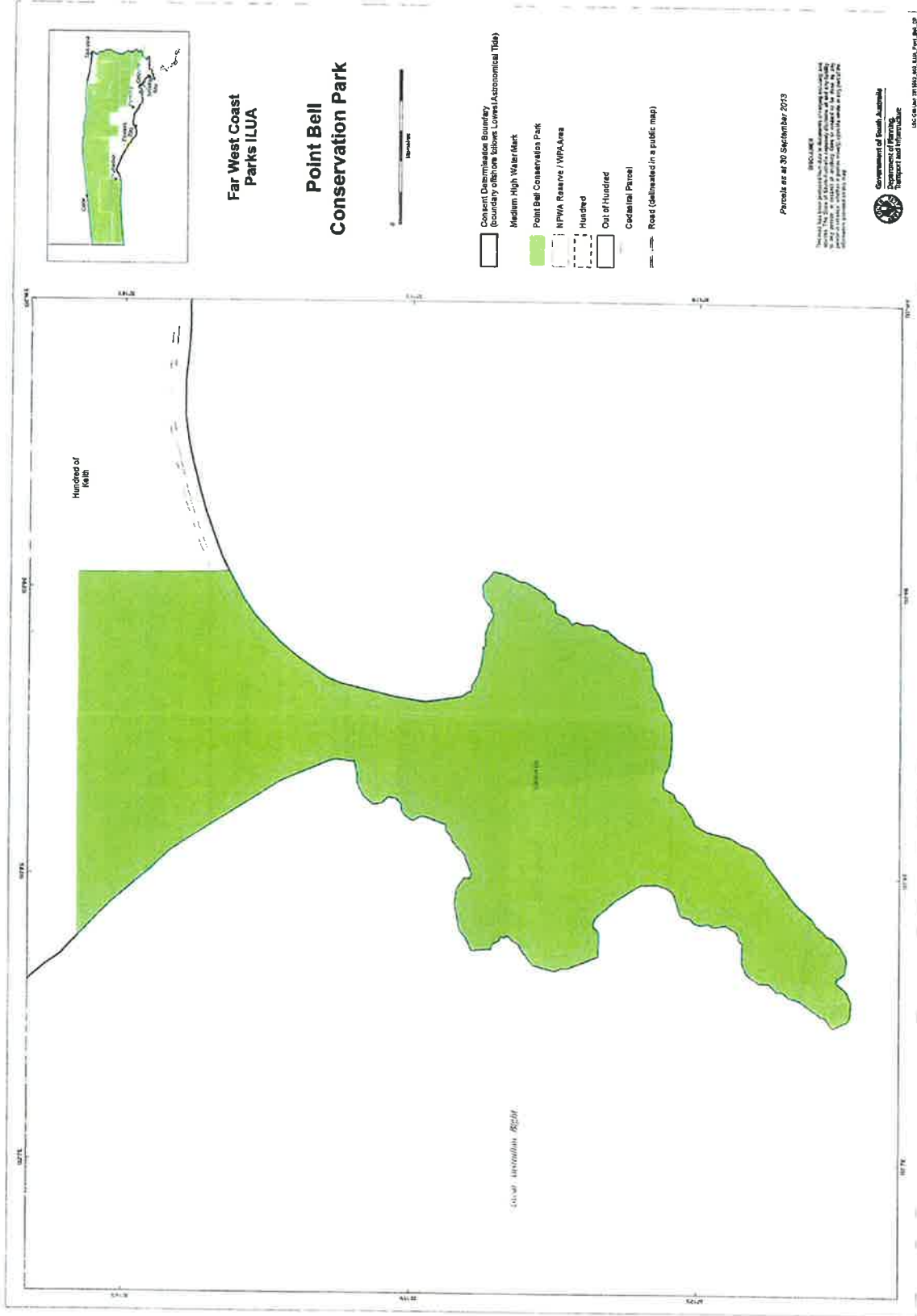

- Consent Determination Boundary
(boundary offshore follows Lowest Astronomical Tide)
- Medium High Water Mark
- Point Bell Conservation Park
- MPWA Reserve / WPA Area
- Hundred
- Out of Hundred
- Coastal Panel
- Road (delineated in a public map)

Parcels as at 30 September 2013

NOT TO SCALE
This map has been prepared for the purpose of providing information only and does not constitute a guarantee, warranty or representation of any kind. The map is provided as a guide only and should not be relied upon for any purpose. The map is provided as a guide only and should not be relied upon for any purpose.



30-09-2013 10:45:00 AM View Page 42

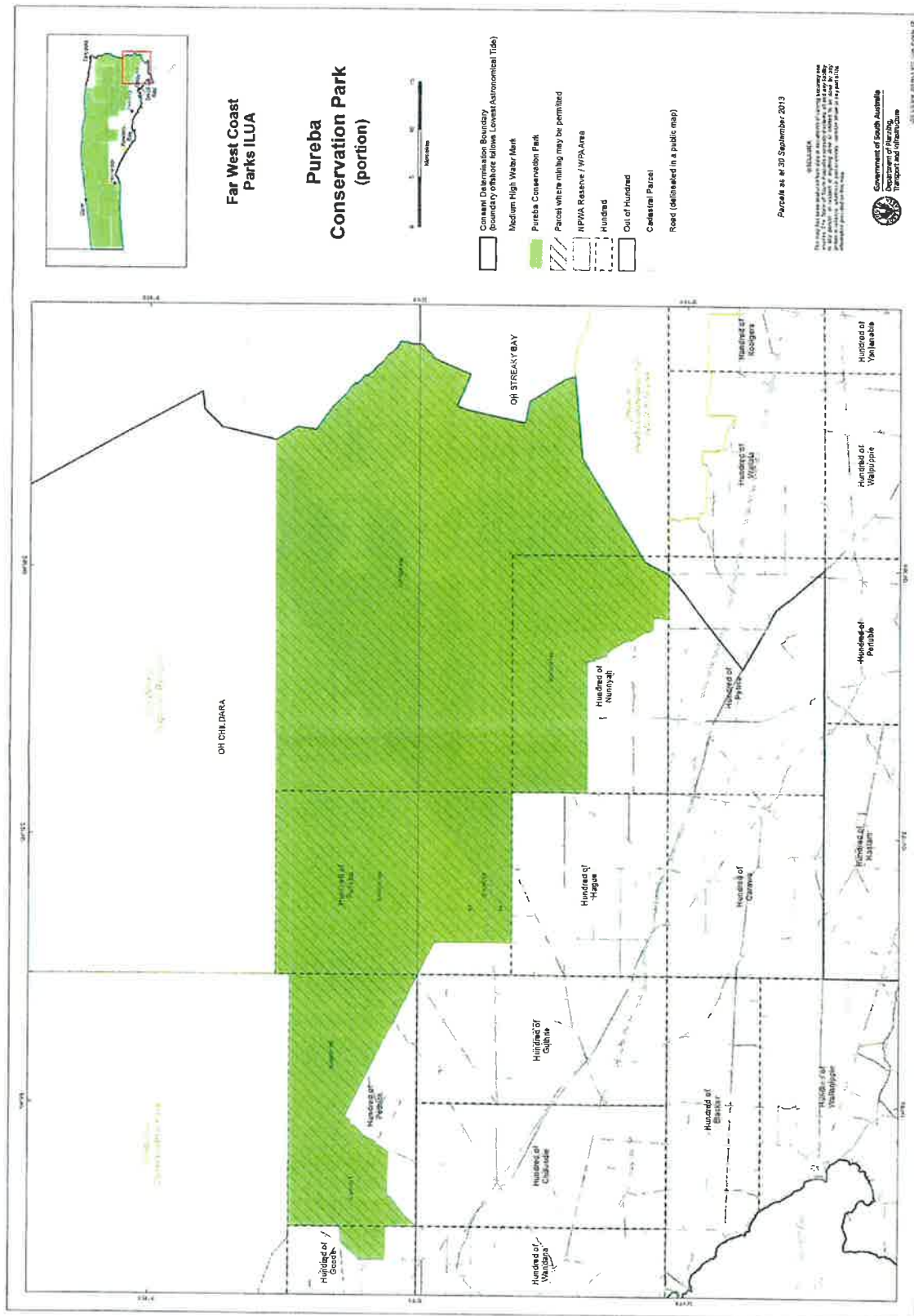

Far West Coast Parks - ILUA

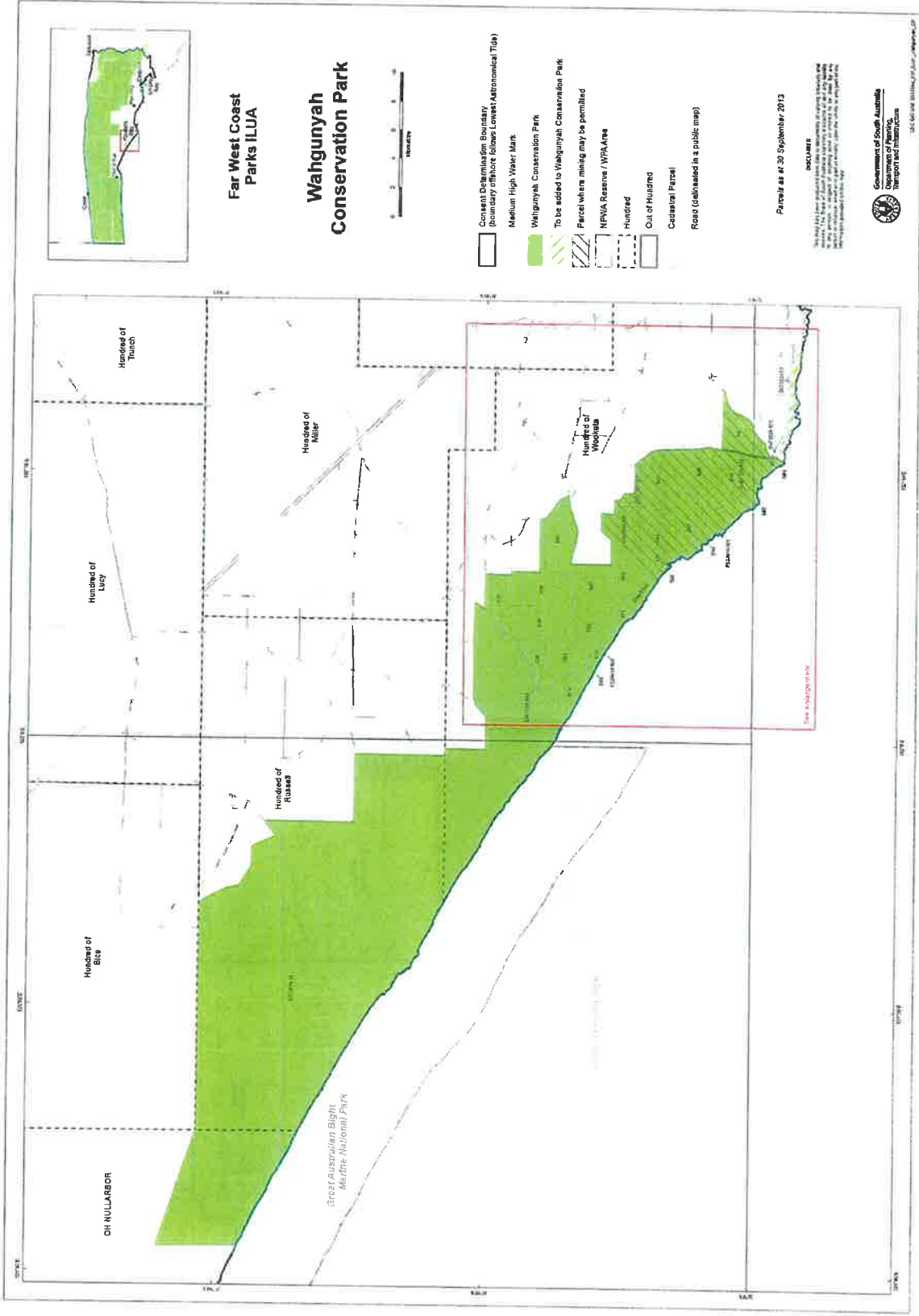

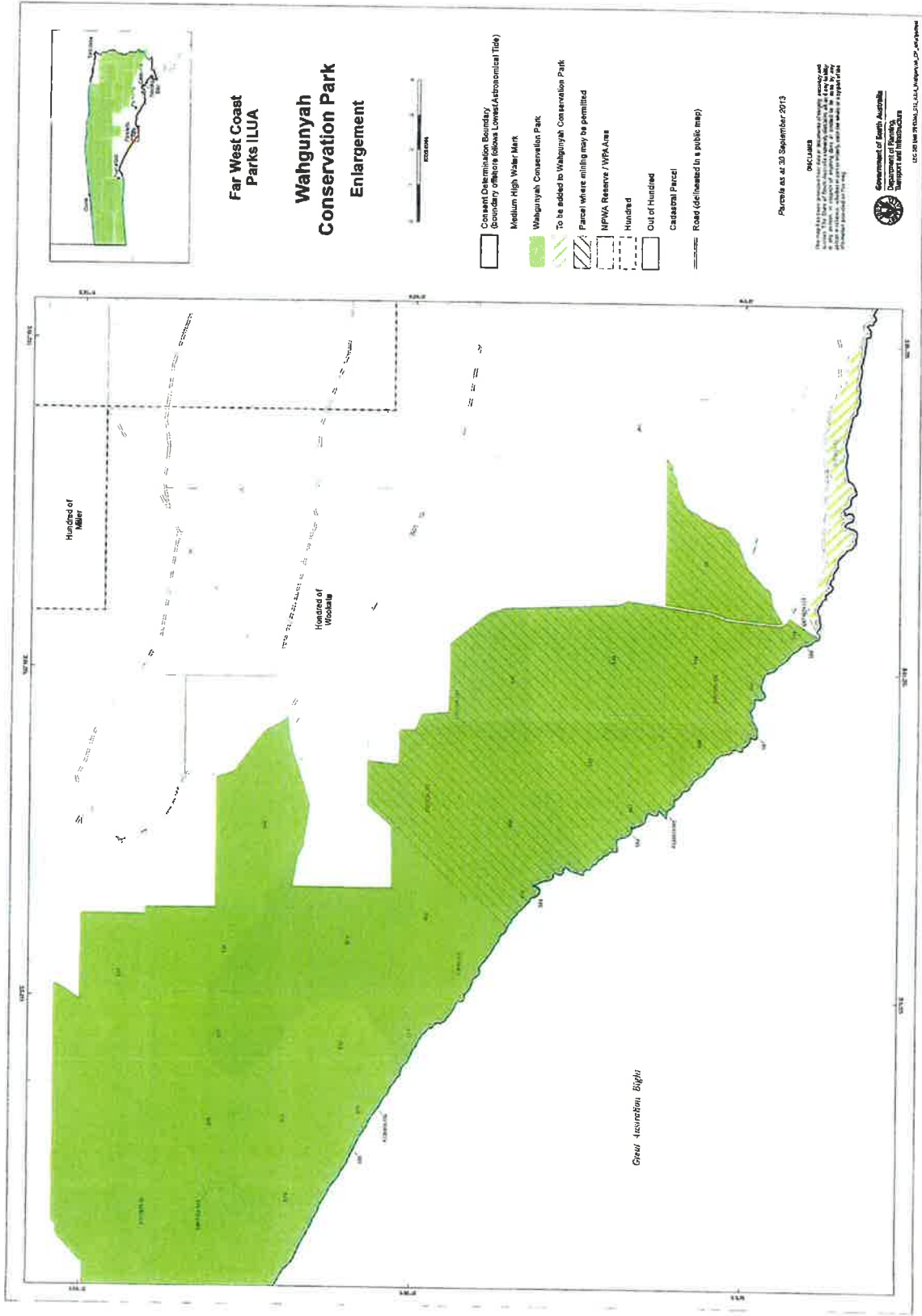

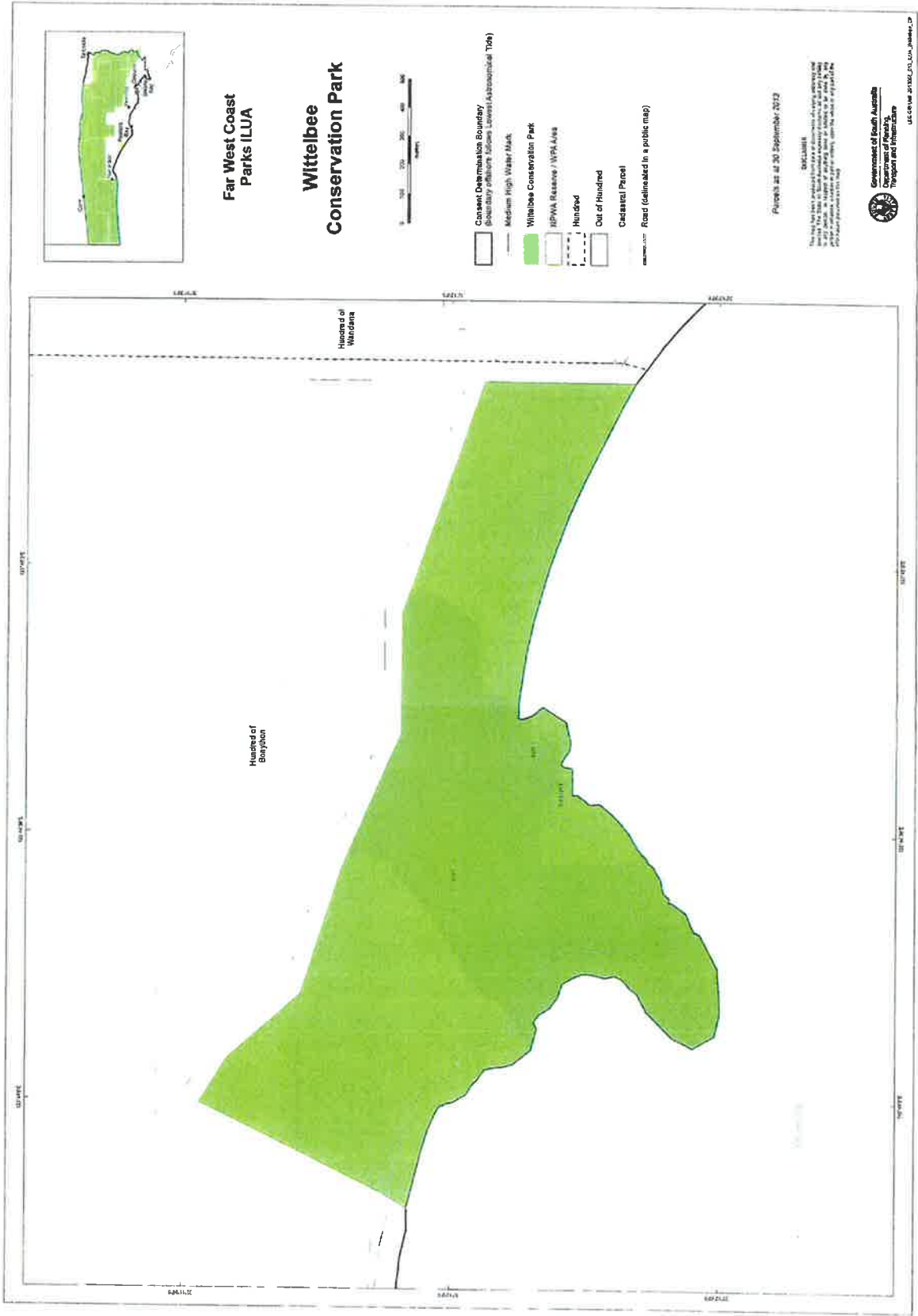

Far West Coast Parks - ILUA

